

(MG 45T)

THREE WAY BALL VALVE FLANGED FULL BORE "L" or "T"

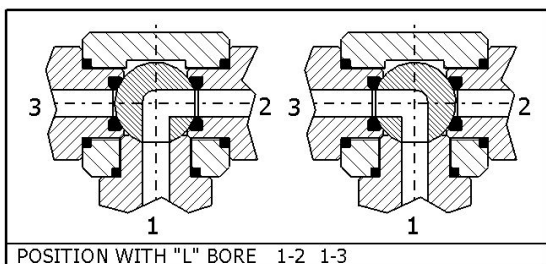

POSITION WITH "L" BORE 1-2 1-3

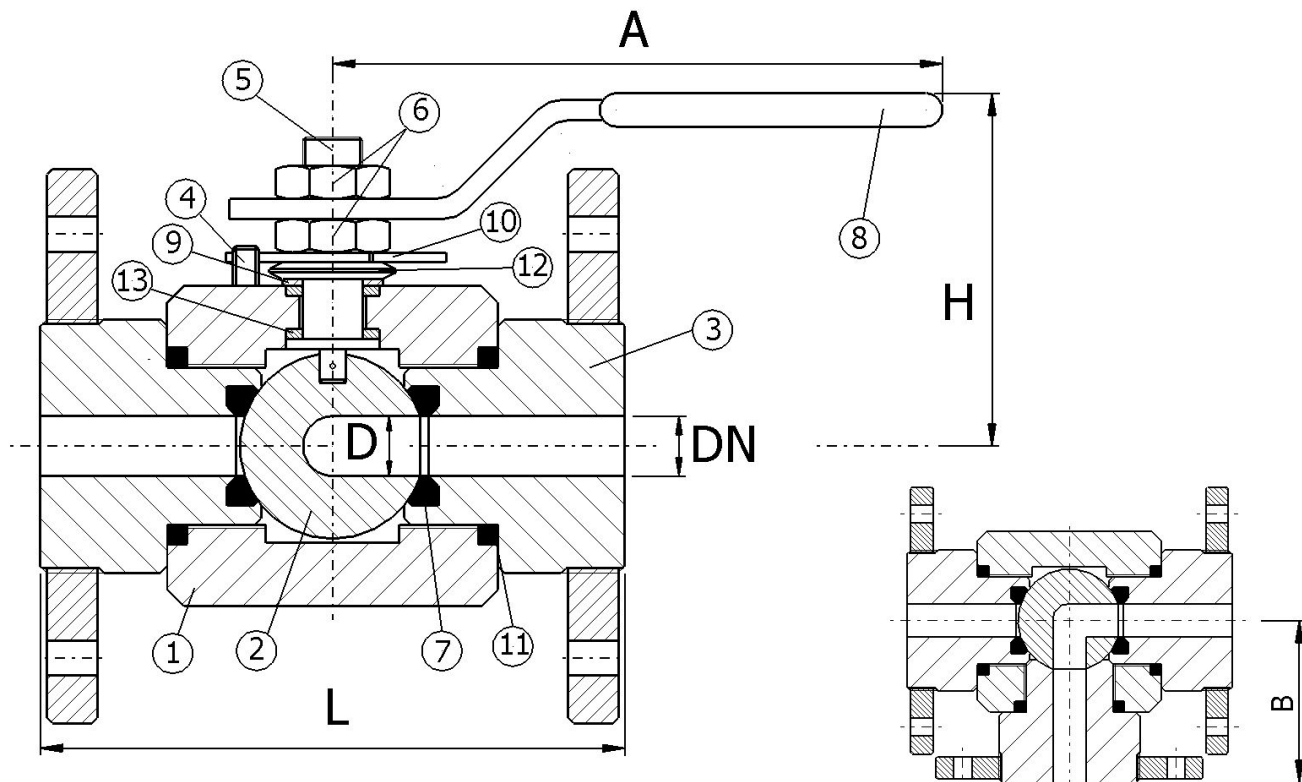
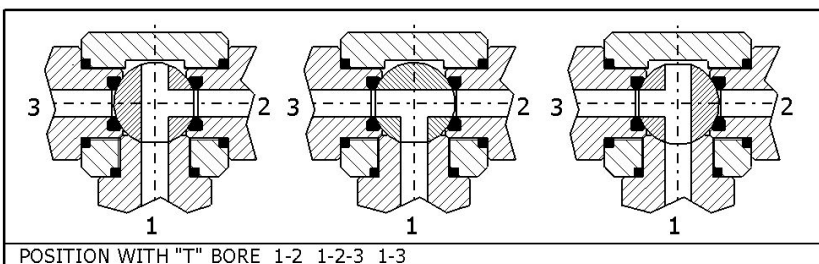

POSITION WITH "T" BORE 1-2 1-2-3 1-3

DIMENSIONS PN10-PN40 ANSI150-ANSI300

DN	15	20	25	32	40			
DN	1/2"	3/4"	1"	1.1/4"	1.1/2"			
L	154	168	178	206	210			
D	14	20	25	32	38			
B	77	84	89	103	105			
H	85	90	95	100	105			
A	185	185	285	285	285			
KG	2.1	2.9	4.6	5.9	9.9			

Standard materials: ASTM A 105-ASTM A 182F316/L

*Other materials upon request.

PART	DESCRIZIONE	DESCRIPTION	*ASTM A105	*ASTM A 182F316/L
1	CORPO	BODY	*ASTM A105	*ASTM A182F316/L
2	SFERA	BALL	*ASTM A182F316	*ASTM A182F316/L
3	CHIUSURA	BODY END	*ASTM A105	*ASTM A182F316/L
4	ARRESTO	STOP	*GALVANIZED STEEL	*GALVANIZED SEEL
5	STELO	STEM	*ASTM A182F316/L	*ASTM A182F316/L
6	DADI	STEM NUTS	*GR6S GALVANIZED	*GR6S GALVANIZED
7	SEDI	SEATS	*PTFE	*PTFE
8	LEVA	HANDLE	*GALVANIZED STEEL	*GALVANIZED STEEL
9	PREMISTOPPA	PRESSING BUSH	*A105 GALVANIZED	*A 105 GALVANIZED
10	ARRESTO	STOP	*GALVANIZED STEEL	*GALVANIZED STEEL
11	ANELLO	RING	*VITON/GRAF.	*VITON/GRAF.
12	MOLLE A TAZZA	SPRING	*C.72 GALVANIZED	*C.72 GALVANIZED
13	GUARNIZIONI	GASKETS	*PTFE/GRAF.	*PTFE/GRAF.

Valves data and characteristic can modified without prior notice.

Via Per Gallarate
21010 BESNATE (VA) Italy
Tel. 0331.274109 Fax. 0331.274565