

THREE WAY BALL VALVE FULL BORE "L" or "T"

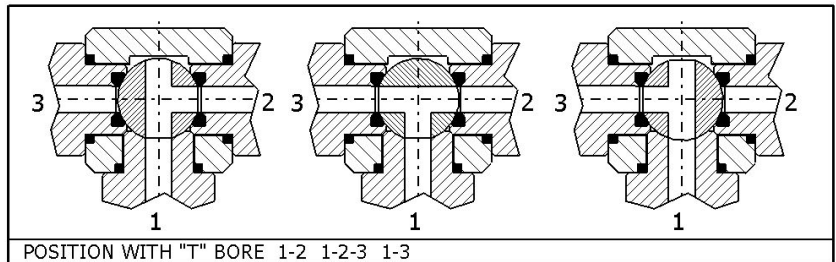
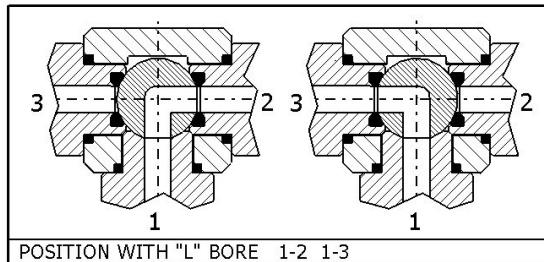
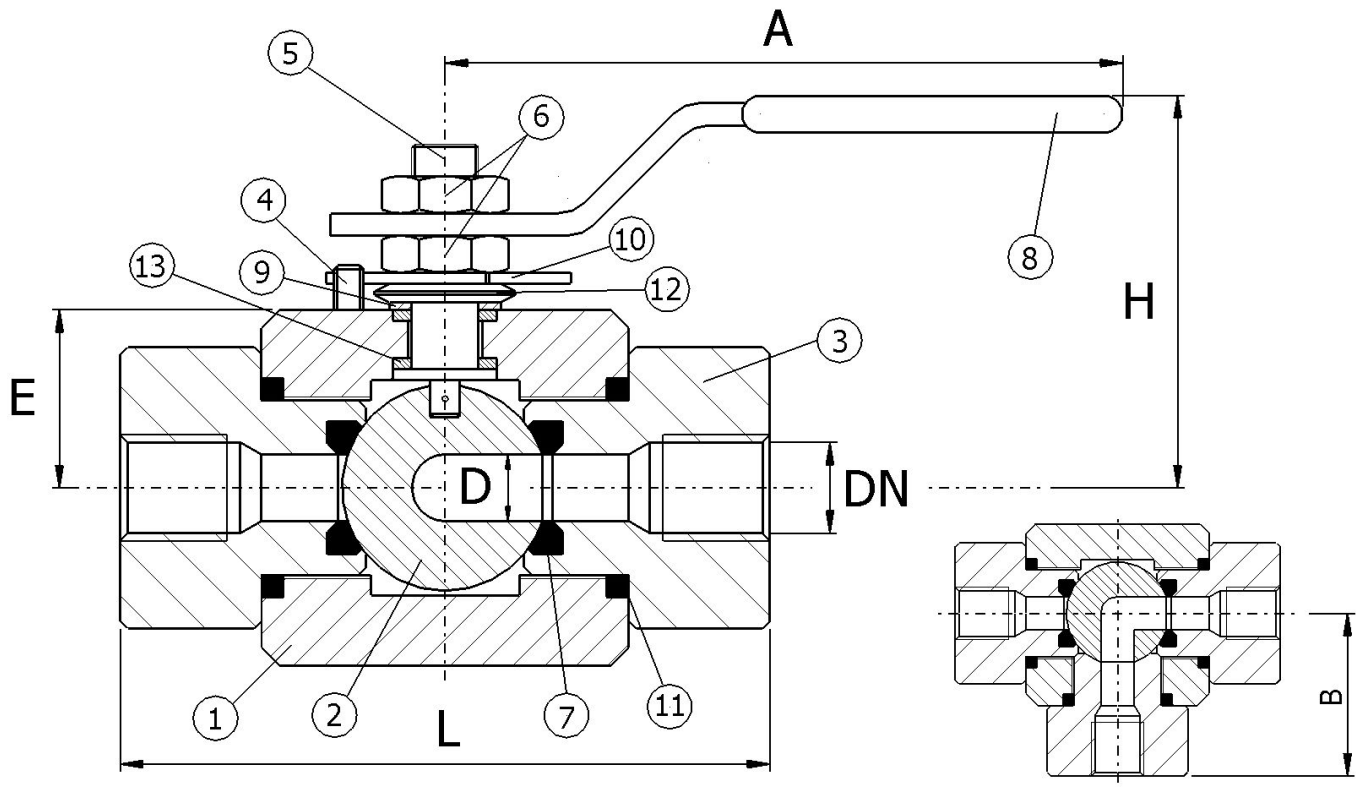

SERIE 800 DIMENSIONS

DN	8	10	15	20	25	32	40
DN	1/4"	3/8"	1/2"	3/4"	1"	1.1/4"	1.1/2"
L	75	75	90	102	120	135	155
D	11	11	14	20	25	32	38
E	22.5	22.5	30	35	40	45	50
B	37.5	37.5	45	51	60	67.5	77.5
H	63	63	85	90	95	100	105
A	150	150	185	185	285	285	285
KG	1.2	1.2	2.1	2.9	4.6	5.9	9.9

Standard materials: ASTM A 105-ASTM A 182F316/L

*Other materials upon request.

PART	DESCRIZIONE	DESCRIPTION	*ASTM A105	*ASTM A 182F316/L
1	CORPO	BODY	*ASTM A105	*ASTM A182F316/L
2	SFERA	BALL	*ASTM A182F316	*ASTM A182F316/L
3	CHIUSURA	BODY END	*ASTM A105	*ASTM A182F316/L
4	ARRESTO	STOP	*GALVANIZED STEEL	*GALVANIZED SEEL
5	STELO	STEM	*ASTM A182F316/L	*ASTM A182F316/L
6	DADI	STEM NUTS	*GR6S GALVANIZED	*GR6S GALVANIZED
7	SEDI	SEATS	*PTFE	*PTFE
8	LEVA	HANDLE	*GALVANIZED STEEL	*GALVANIZED STEEL
9	PREMISTOPPA	PRESSING BUSH	*A105 GALVANIZED	*A 105 GALVANIZED
10	ARRESTO	STOP	*GALVANIZED STEEL	*GALVANIZED STEEL
11	ANELLO	RING	*VITON/GRAF.	*VITON/GRAF.
12	MOLLE A TAZZA	SPRING	*C.72 GALVANIZED	*C.72 GALVANIZED
13	GUARNIZIONI	GASKETS	*PTFE/GRAF.	*PTFE/GRAF.

Valves data and characteristic can modified without prior notice.

THREE WAY BALL VALVE REDUCED BORE "L" or "T"

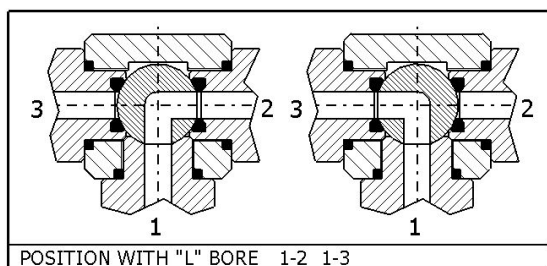
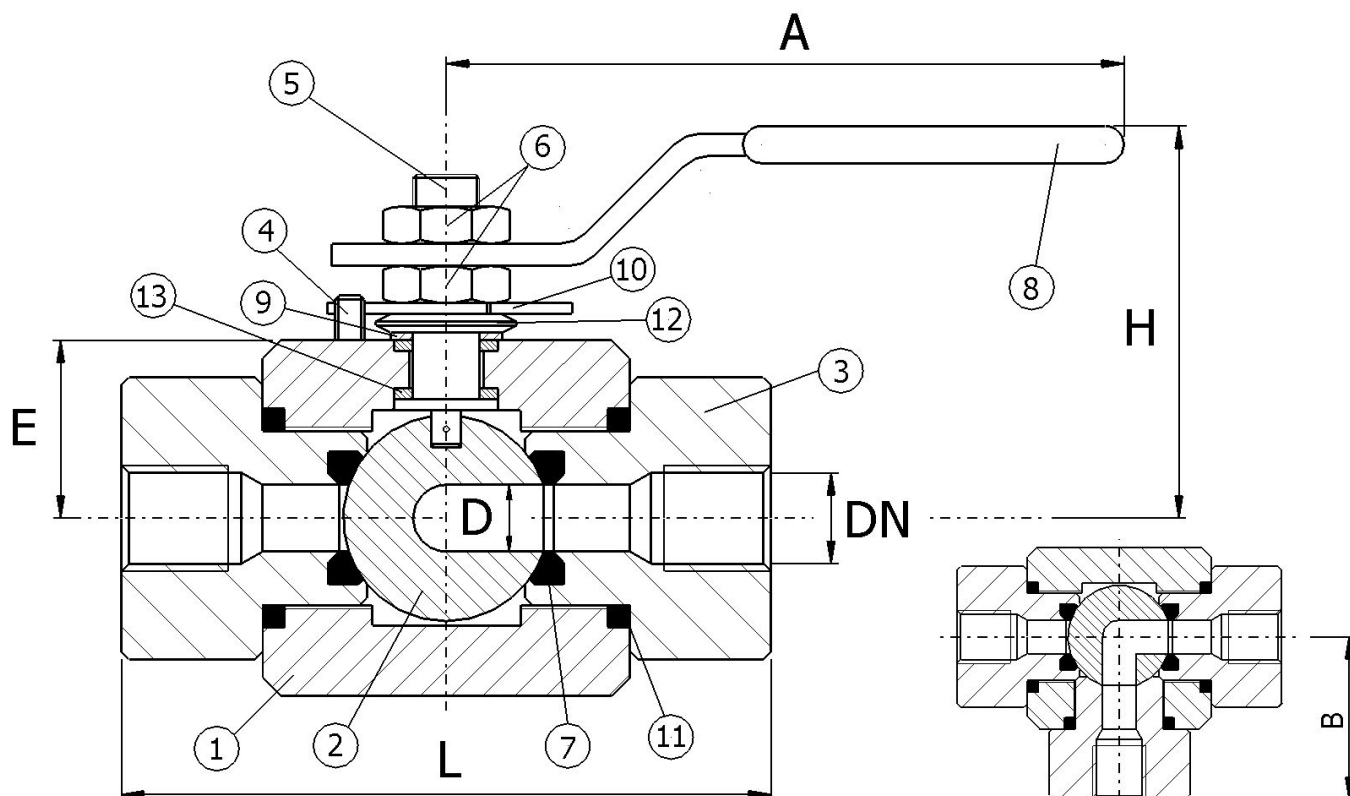

POSITION WITH "L" BORE 1-2 1-3

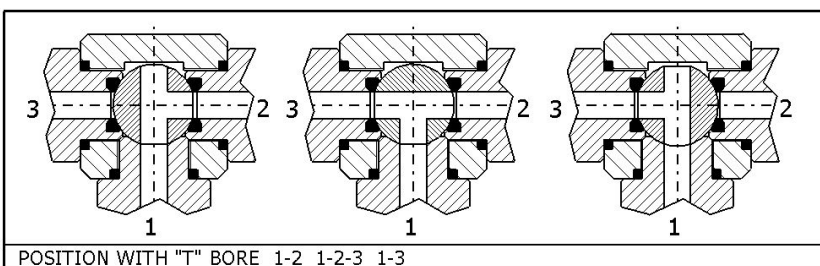

POSITION WITH "T" BORE 1-2 1-2-3 1-3

SERIE 800 DIMENSION

DN	8	10	15	20	25	32	40	50
DN	1/4"	3/8"	1/2"	3/4"	1"	1.1/4"	1.1/2"	2"
L	75	75	75	90	102	120	135	155
D	11	11	11	14	20	25	32	38
E	22.5	22.5	22.5	30	35	40	45	50
B	37.5	37.5	37.5	45	51	60	67.5	77.5
H	63	63	63	85	90	95	100	105
A	150	150	150	185	185	285	285	285
KG	1.2	1.2	1.2	2.1	2.9	4.6	5.9	9.9

Standard materials: ASTM A 105-ASTM A 182F316/L

*Other materials upon request.

PART	DESCRIZIONE	DESCRIPTION	*ASTM A105	*ASTM A 182F316/L
1	CORPO	BODY	*ASTM A105	*ASTM A182F316/L
2	SFERA	BALL	*ASTM A182F316	*ASTM A182F316/L
3	CHIUSURA	BODY END	*ASTM A105	*ASTM A182F316/L
4	ARRESTO	STOP	*GALVANIZED STEEL	*GALVANIZED SEEL
5	STELO	STEM	*ASTM A182F316/L	*ASTM A182F316/L
6	DADI	STEM NUTS	*GR6S GALVANIZED	*GR6S GALVANIZED
7	SEDI	SEATS	*PTFE	*PTFE
8	LEVA	HANDLE	*GALVANIZED STEEL	*GALVANIZED STEEL
9	PREMISTOPPA	PRESSING BUSH	*A105 GALVANIZED	*A 105 GALVANIZED
10	ARRESTO	STOP	*GALVANIZED STEEL	*GALVANIZED STEEL
11	ANELLO	RING	*VITON/GRAF.	*VITON/GRAF.
12	MOLLE A TAZZA	SPRING	*C.72 GALVANIZED	*C.72 GALVANIZED
13	GUARNIZIONI	GASKETS	*PTFE/GRAF.	*PTFE/GRAF.

Valves data and characteristic can modified without prior notice.